

 User manual and warranty for Cafissimo Pure

Contents

- 2 Intended use and location
- 2 About these instructions
- 3 Safety warnings
- 5 At a glance
- 6 Initial operation - prior to first use
- 6 Rinsing the machine
- 7 Using large / small cups or glasses
- 7 The finest aroma - the finest flavour
- 8 Brewing coffee
- 9 Adjusting the strength of the coffee
- 9 Releasing pressure
- 10 Standby mode
- 10 Cleaning
- 11 Descaling
- 12 For a long period of non-use
- 13 Problems / solutions
- 14 Warranty
- 14 Technical specifications
- 14 Disposal
- 15 Service Form

Intended use and location

The coffee machine has been devised for the following uses:

- Brewing filter coffee, caffè crema and espresso with Tchibo capsules.

It has been designed for use in households or for similar applications such as

- in shops, offices or similar work areas,
- agricultural buildings,
- by customers in hotels, motels, bed and breakfast establishments or other places offering accommodation.

Set up the machine in a dry, indoor room. Avoid rooms with high humidity or high dust content. The machine is suitable for use at ambient temperatures of +10 to +40°C.

About these instructions

Read these safety warnings carefully and only use the machine as described in these instructions to avoid accidental injury or damage. Keep these instructions for future reference.

If you pass the machine on to another person, remember to give them these instructions.

Symbols in these instructions:



This symbol warns you of the danger of injury.



This symbol warns against the danger of injury caused by electricity.

Signal words:

DANGER warns you of potential severe injuries and danger to life.

WARNING warns you of injuries and severe material damage.

CAUTION warns you of minor injuries or damage.



This indicates additional information.

Safety warnings



DANGER to children and people with a restricted capability of operating appliances

- Children must not be allowed to play with the machine. Keep the machine and mains cord away from children under the age of 8.
- This machine can be used by children aged 8 and over or by people with reduced physical, sensory or mental capabilities, or who lack experience and/or knowledge, provided they are supervised or have been trained in the safe use of the machine and understand the potential dangers.
- Children must not be allowed to clean the machine unless they are over 8 years of age and supervised while doing so. This machine is maintenance free.
- Set up the machine out of the reach of children.
- Keep the packaging material out of the reach of children. There is a risk of suffocation!

DANGER due to electricity

- Never immerse the coffee machine, mains plug or mains cord in water, as this could cause an electric shock. Never touch the mains plug with wet hands. Do not use the machine outdoors.
- Never leave the machine to operate unattended.

- Only connect the machine to a properly installed, grounded wall socket. The mains voltage must comply with the requirements stated in the machine's technical specifications.
- The mains cord must not be kinked or squeezed. Keep it away from sharp edges and sources of heat.
- Do not use the machine if the machine, mains cord or mains plug is damaged or if the machine has been dropped.
- Do not make any modifications to the machine, mains cord or other parts. Electrical appliances must only be repaired by qualified electricians, as improper repairs can cause considerable damage. Only have repairs carried out by a specialist workshop, or contact the customer care service.
- Remove the mains plug from the wall socket...
 - ... if a fault occurs,
 - ... if the machine will not be used for any length of time,
 - ... before cleaning the machine.To unplug, always pull on the mains plug, not the cord.

WARNING - risk of scalds/burns

- Do not touch the coffee spout during or immediately after use. Avoid contact with coffee being dispensed from the spout.

- Do not raise the lever while the machine is being used. Keep the capsule opening closed and do not pull out the used capsule container.

CAUTION - risk of injuries or material damage

- **Use only original Tchibo Cafissimo capsules.** Neither use capsules from other manufacturers, nor damaged or misshapen capsules, and never fill capsules or the machine with ground coffee or instant coffee, as this would damage the machine. In these cases, any necessary repairs would not be covered by the warranty.
- Only use the machine with the used capsule container and drip grid inserted.
- Always pour fresh, cold tap or other drinking water into the water tank. Do not use carbonated mineral water or any other liquids.
- Descale the machine as soon as the machine indicates that this is necessary.
- The capsule compartment contains two capsule punchers. These punchers pierce both sides of the capsule when the lever is pressed down. Never reach into the capsule compartment. Keep your fingers and any objects away from the capsule compartment as you fold down the lever.
- Do not lift the machine up by the lever. To move the machine, hold it by the outer casing.
- Place the machine on a solid, level surface that is well illuminated and resistant to water and heat.
- To ensure that the casing does not melt, do not place the machine on a hob or immediately next to a hot oven, radiator or anything similar.
- Route the mains cord in such a way that it cannot be tripped over. Do not let the mains cord hang down from the surface the machine is put on so that the machine cannot be pulled down by it.
- The machine is equipped with non-slip feet. Work surfaces often have varnished or plastic finishes and are treated with a variety of care products. Some of these may contain substances that react adversely to the non-slip feet and soften them. If necessary, place a non-slip mat under the machine.
- The machine must not be exposed to temperatures below 4°C. Residual water in the heating system could freeze and cause damage.

At a glance

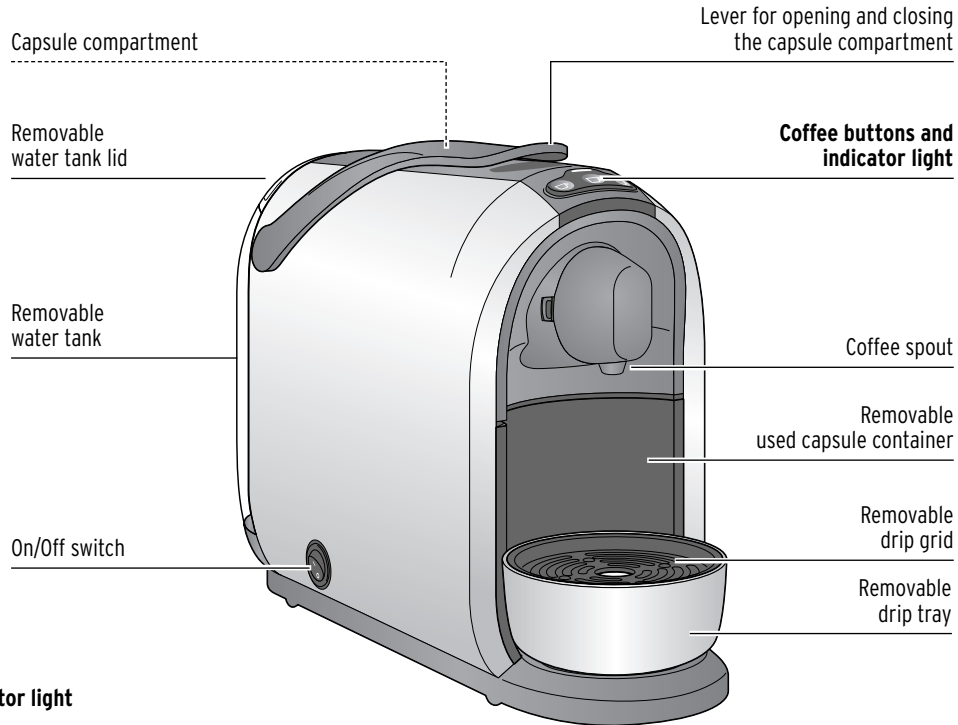

Coffee buttons and indicator light

(The colours of the buttons are visible only when the machine is switched on.)



Making espresso
(small white cup
for black capsule)



Making caffè crema
(yellow cup for
yellow capsule)
Making tea
(Cafissimo tea capsules)



**Making filter
coffee**
(blue cup for
blue capsule)

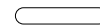

Indicator light

- Flashes red (**water tank empty**)
- Lights up yellow (**machine needs to be descaled**)
- Flashes red and yellow (**during the descaling process**)

Initial operation - prior to first use

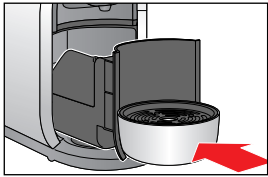

1. Make sure that the used capsule container is pushed all the way in and that the drip tray is correctly in place.

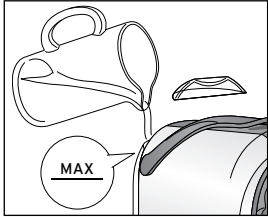

2. Fill the water tank with fresh, cold tap water or drinking water up to the MAX mark.
 - Either pour the water through the opening in the water tank as illustrated or

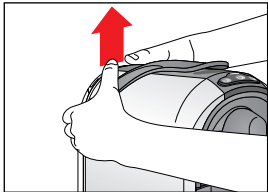

- take hold of the sides of the water tank as illustrated and pull it up and out. Fill it with water. When inserting it, press the water tank down as far as it will go to ensure that the valve in the base engages in the casing.

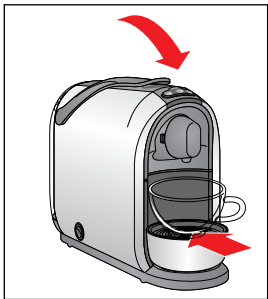

3. The lever must be in the down position. Fold it down if necessary.
4. Place a cup beneath the coffee spout.

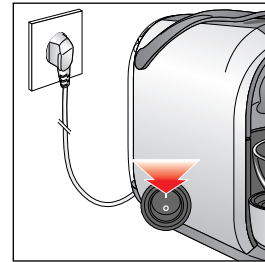

5. Plug the mains plug into an easily accessible wall socket.
6. Press the On/Off switch to switch on the machine.



- The coffee buttons and indicator light flash.
7. Press any coffee button.

The pump starts to operate. As soon as the pipes are filled with water the pump stops automatically. A small quantity of water runs into the cup beneath the spout.



The indicator light goes out. Only the three coffee buttons then continue to flash and the machine heats up to prepare the coffee.

8. Pour away the water that is in the cup and rinse the machine twice as described in the next section. The machine is then ready for use.

Rinsing the machine

After switching the machine on for the first time or if you have not used the machine for longer than two days, rinse the machine by allowing two cups of water to flow through it (without a capsule).

The finest aroma - the finest flavour

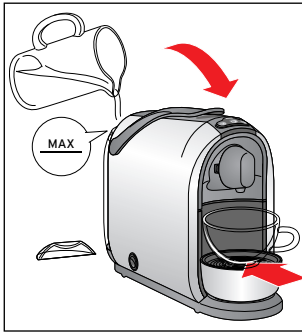

1. Fill the water tank with fresh, cold tap water or drinking water up to the MAX mark.
2. Place an empty cup beneath the spout.
3. The lever must be in the down position.



4. As soon as the three coffee buttons remain permanently lit, press the middle one.

The pump will flush water through the pipes to be dispensed into the cup below.

5. Pour the water away.
6. Repeat steps 2 to 5.
7. Finally, empty the drip tray and the used capsule container:

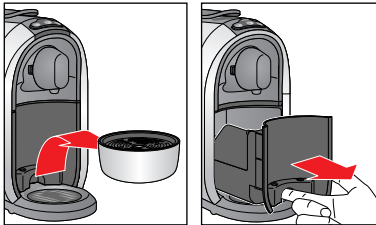

To do so, lift the drip tray up and off, and remove the grid.

Then pull out the used capsule container as illustrated.

8. Empty the drip tray and the used capsule container.
9. Reinsert all parts in the machine.

One capsule per cup

Each capsule is a single portion for one cup.

Full aroma

Only insert a capsule when you intend to use the machine. The capsule is pierced as it is inserted. If it is not used immediately, the aroma will fade.

Preheating the cup

Fill the cup with hot water and then pour it away shortly before using the cup. This helps espresso, caffè crema and filter coffee taste their best.

Coffee strength

Adjust the strength of the coffee to suit your personal taste by changing the quantity of water. This is very easy to do, and is described in the section "Adjusting the strength of the coffee".

Using large / small cups or glasses

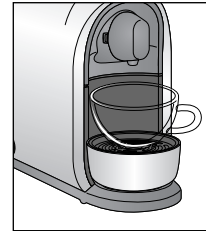

For large cups, leave the drip grid in place.



For small cups, simply turn the drip grid over.



For glasses, remove the whole drip tray.

Brewing coffee

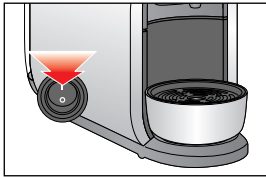

1. Press the On/Off switch to switch on the machine. If the machine is in standby mode (see "Standby mode"), press a coffee button or move the lever.



The three coffee buttons flash as the machine heats up. The machine loses pressure as it heats up. A little residual water may also escape from the coffee spout at the same time.

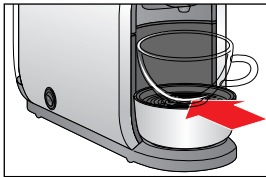

2. Place a cup beneath the coffee spout.

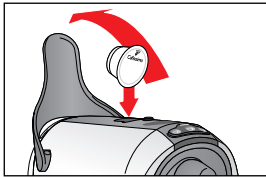

3. Fold back the lever as far as it will go and insert a capsule as illustrated with the lid facing forwards.

The capsule must be intact:

Do not pierce it and **do not** remove the capsule lid or insert a misshapen capsule!

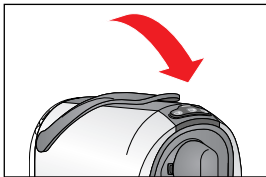

4. Fold the lever fully down.

This action pierces the base and lid of the capsule.



As soon as the three coffee buttons remain permanently lit the machine is ready for use.

5. Press the coffee button that corresponds to the capsule you have inserted. The brewing process starts and stops automatically.

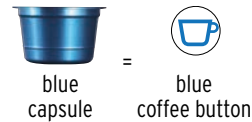

i As is the case with professional espresso machines, a small quantity of coffee is pre-brewed. This enhances the aroma. This process can be identified by the short pause at the beginning of the brewing process. Filter coffee is prepared without a pre-brewing process, just like with standard coffee machines.

Tip: You can adjust the strength of the coffee by adjusting the quantity of water. Refer to the section "Adjusting the strength of the coffee" for information on how to do this.

If you would like to stop the brewing process prematurely, press the same coffee button again while brewing.

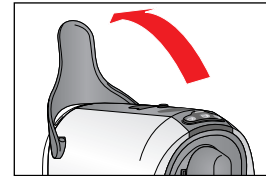

6. Before removing the coffee cup, fold back the lever as far as it will go.

The machine loses pressure and a little more coffee will escape. The capsule then falls into the used capsule container.

7. After use...

- ... empty the water in the drip tray. Due to how the machine operates there will always be water and a small residue of coffee grounds collected in the tray.
- ... empty the used capsule container daily or whenever it is full. Approx. 6 capsules fit inside.



Always remove used capsules from the machine. Empty out the used capsules daily. In case you forget a capsule in the machine for a few days, rinse the machine as described in the section "Rinsing the machine".

Adjusting the strength of the coffee

Adjust the strength of the coffee to suit your personal taste by adjusting the quantity of water. You can do this for one single brewing procedure or save the setting.

Adjusting the strength for the current brewing procedure (without saving the setting)

- ▷ If the coffee is **too weak**, you can stop the water flow prematurely by pressing the flashing coffee button.
- ▷ If the coffee is **too strong**, start the brewing procedure again without inserting a new capsule. Press the button as soon as sufficient water has run through.

Default settings (amounts are approximate):

Espresso 40 ml | **Caffè crema** 125 ml | **Filter coffee** 125 ml

The water quantity can be set to between approx. 30 and 300 ml.

Setting the strength permanently (saving the setting)

You can change the factory settings for the water flow permanently. This enables you to make your favourite coffee every time at exactly the strength you prefer. You can customise the setting for each type of coffee: espresso (white cup), caffè

crema (yellow cup) and filter coffee (blue cup).

1. Proceed in the same way as for brewing coffee: Fill the water tank, insert a capsule and place a cup beneath the spout.
2. Press and hold the relevant coffee button until the required quantity of coffee has been dispensed into the cup.
3. When you release the button, the machine will save that quantity.

If the settings are not to your taste, simply repeat the procedure to change them again.

Restoring the factory settings

You can restore the original settings for the water quantity.

1. Press the On/Off switch to switch off the machine.

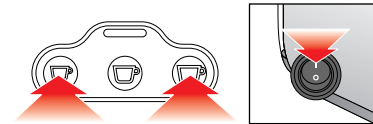

2. Press and hold the left and right coffee buttons and switch the machine on.

3. Release the buttons.

The factory settings for the water quantity have been restored.

Releasing pressure

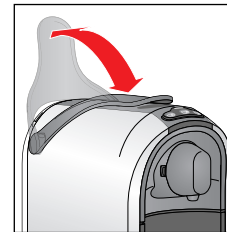

Always fold back the lever after each brewing procedure. The capsule will fall out and the pressure in the system will subside.

Fold the lever down again when you are not using the machine in order to close the capsule compartment.

Standby mode

Standby

The machine automatically switches to standby mode 9 minutes after the brewing procedure. The three coffee buttons go out. The machine now uses only a very small amount of electricity but is ready for use at any time. Press one of the coffee buttons or move the lever to reactivate the machine.

Switching off completely

If you are not using the machine for any length of time, e.g. overnight, switch it off completely using the On/Off switch on the side of the machine. This means that it will not use up any more electricity.

Cleaning



DANGER - risk of fatal electric shock

- Before cleaning the machine, press the On/Off switch to switch off the machine and unplug the mains plug from the wall socket.
- Never immerse the machine, mains plug or mains cord in water or any other liquids.
- Do not clean the machine with a water jet. Clean it only as described in the following instructions.

CAUTION - material damage

Do not use any caustic, aggressive or abrasive products for cleaning.

Cleaning the casing

- ▷ Wipe the casing with a soft, damp cloth.
- ▷ Also wipe the compartment for the used capsule container with a soft, damp cloth as required.

Cleaning the water tank

The water tank should be cleaned once a week.

- ▷ Wash the water tank in water and a mild washing-up liquid. Rinse it out thoroughly under running water and dry it. The tank is not dishwasher-safe.

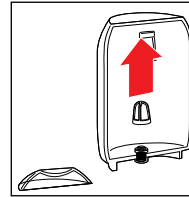

The filter in the water tank can be removed in order to remove limescale, etc.

1. Pull it up and out.
2. Rinse it off under running water.
3. Then reinsert it in the opening in the water tank, pressing it in as far as it will go.



In case you cannot remove the filter (for example, if you cannot reach it): Rinse out the water tank daily under running water. This will prevent limescale deposits from forming or other particles clogging the filter in the bottom of the water tank.

Cleaning the used capsule container and drip tray/grid

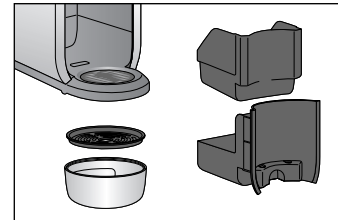

1. Remove the drip tray.
2. Take the drip grid out of the drip tray and empty the drip tray
3. Pull out the used capsule container and remove the insert from the container.
4. Empty the used capsule container.
5. Wash all parts using washing-up liquid. Then dry all parts thoroughly. The plastic parts are not dishwasher-safe. Only the drip grid can be cleaned in a dishwasher.
6. Then reinsert all parts in the machine.

Cleaning the coffee spout

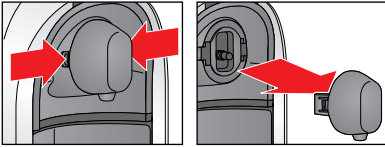

1. Press the two tabs on the sides of the coffee spout in all the way and pull the coffee spout forwards and off.

2. Wash the coffee spout with warm water and a little mild washing-up liquid. Then rinse it thoroughly with clear water and dry it well.
3. Reinsert the coffee spout. You should hear and feel it click into place.

Descaling

CAUTION - damage to the machine due to limescale deposits

- **Descal the machine as soon as the machine indicates that this is necessary** (after approx. 50 litres).

This increases its service life and saves energy.

- Do not use any descaling agents made on the basis of formic acid.
- Use a standard liquid descaling agent suitable for coffee and espresso machines. Other agents may damage materials in the machine and/or have no effect.

Tip: Descaling agent: durgol® swiss espresso® is available from any Tchibo branch and from specialist retailers.



If the indicator light lights up yellow, the machine needs to be descaled. Do this within the next couple of days. Do not wait any longer, otherwise so much limescale may collect that a descaling agent will no longer have any effect.

Descaling takes about 50 minutes.

1. Press the On/Off switch to switch off the machine.

Using durgol® swiss espresso®:

- ▷ Take the water tank out of the machine and pour one portion (125 ml) of durgol® swiss espresso® into the empty water tank. Add water up to the MAX mark. Replace the tank.
 - ▷ If you are using a different descaling agent, read the manufacturer's instructions. Add descaling solution up to the MAX mark. Reinsert the tank.
2. Fold down the lever.
 3. Place a container with a capacity of at least 250 ml under the coffee spout. Remove the drip tray if necessary.

You will need to empty the container several times during the descaling procedure.

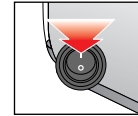
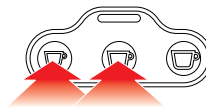

4. Press and hold the left and middle coffee buttons and press the On/Off switch to switch the machine on.

5. Release the buttons.

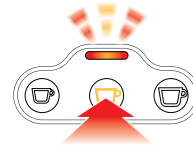

6. The middle coffee button lights up and the indicator light flashes red and yellow. Press the middle coffee button to start descaling.

The descaling procedure begins. The indicator light flashes red and yellow alternately. **The process takes approx. 50 minutes.**

The machine pumps descaling solution into the pipes several times at 10-minute intervals. Each time about 125 ml is dispensed into the container.

For a long period of non-use

7. Pour out the dispensed water each time to ensure that the container does not overflow.



Once completed, the middle coffee button lights up again and the indicator light flashes red and yellow.

8. Clean the water tank, used capsule container, drip tray, grid and coffee spout as described in the section "Cleaning".

Rinsing phase

9. To start the rinsing phase, rinse out the water tank using fresh water and fill it with cold tap water to the MAX mark.
10. Place an empty container (at least 250 ml) beneath the coffee spout.



11. Press the middle coffee button to start rinsing.
The indicator light flashes 2x yellow and 2x red alternately.

12. Approx. 500 ml water will be rinsed through the system. Keep an eye on the container and empty it before it overflows.



13. Once completed, the middle coffee button lights up again and the indicator light flashes red and yellow alternately.
Press the middle coffee button.
The descaling procedure is completed.



All three coffee buttons flash. The machine is heating up to brew coffee.

If you will not be using the machine for a prolonged period, e.g. when you go on holiday, we recommend for reasons of hygiene that you should remove the water from the machine's pipes. Proceed as follows:

1. Press the On/Off switch to switch off the machine.
2. Place a container beneath the coffee spout.
3. Fold down the lever if necessary.
4. Empty the water tank and reinsert it.



6. Release the buttons again.



The indicator light flashes red.

The pump transports the remaining water out of the pipes of the machine. It stops automatically as soon as there is no more water inside.

The residual water runs into the container beneath the spout.

A signal sounds and the indicator light continues to flash red.

7. Press the On/Off switch to switch off the machine.
8. Fold back the lever to allow the pressure in the system to subside. A little more water will drip from the spout.
9. Then fold down the lever again to close the capsule compartment.

When you wish to use the machine again at a later time, proceed as described in the section "Initial operation - Prior to first use".

Problems / solutions

The indicator light is flashing red and a signal is sounding.

Is the water tank empty?

- ▷ Fill the water tank with fresh water.
- ▷ Press one of the coffee buttons. The pump starts to operate. As soon as the pipes are filled with water the pump stops automatically.
- ▷ When the coffee buttons remain permanently lit, the machine is ready for use again.

Has the lever been raised during the brewing procedure?

This will immediately stop the brewing procedure.

- ▷ Fold down the lever again.
- ▷ Press one of the coffee buttons to switch off the acoustic signal.

No coffee or only a little coffee is flowing out.

If the indicator light is flashing red, the water tank is empty. Fill it and press a coffee button to fill the pipes with water again.

Water is dripping out of the coffee spout.

The water in the system expands as the machine heats up and as a result a little water drips out of the coffee spout. During brewing, the water is pressed through the capsule at high pressure. If at the end the lever is moved, the machine loses pressure and coffee escapes. This is a feature of the system and is not a fault. For this reason, you should not remove the cup with the freshly brewed coffee from the drip grid until after you have fully folded back the lever.

There are coffee grounds in the cup.

A small residue of coffee grounds always remains at the bottom of the cup. This is a feature of the system and is not a fault.

The coffee is not hot enough.

Especially in the case of espresso, the quantity of coffee is so small compared with the size of the cup that it quickly cools down. Preheat the cup by filling it with hot water and pouring it away shortly before using the cup.

The indicator light lights up yellow.

The machine needs to be descaled. Do this within the next couple of days. Do not wait any longer, otherwise so much limescale may collect that a descaling agent will no longer have any effect. A self-induced defect of this kind will not be covered by the warranty. Proceed as described in the section "Descaling".

It is not possible to press down the lever.

Check whether the used capsule container is full. Empty it if necessary. If a capsule is trapped in the compartment, fold the lever fully back and press the capsule through from the top to the bottom. Do not reinsert a capsule if it is misshapen.

Warranty

We grant a **36-month warranty** from the date of purchase.

Tchibo GmbH, Überseering 18, 22297 Hamburg, Germany

We will remedy all defects in workmanship or materials within the warranty period. In order for the warranty to be granted, all warranty claims must be accompanied by proof of purchase from Tchibo or from an authorised Tchibo distribution partner. This warranty is only valid within the EU, Switzerland and Turkey.

If, contrary to our expectations, a defect is found, please contact our customer care service at the following e-mail address:

service@tchibo.de

Our customer consultants will be pleased to advise you on further procedure.

Damage due to improper use, failure to decalcify as well as worn parts and consumables, are not covered by the warranty.

Please have the product number at hand in case of any queries.

This warranty does not restrict statutory warranty rights.

Product number



Product number

You can find your Cafissimo machine's product number on the type plate on the

bottom of the casing. Before laying the Cafissimo on its side, remove the water tank, the drip tray and the used capsule container. Lay a cloth or mat underneath the machine to protect the surface from remaining water and coffee that may leak out.

Technical specifications

Type / Model:	Cafissimo 325516
Product number:	see "Warranty" section
Mains voltage:	220-240 V ~ 50 Hz
Power:	1250 watts
Power consumption when turned off:	0.04 watts
Automatic switch-off:	approx. 9 minutes
Protection class:	I
Pump pressure:	15 bar
Sound pressure level:	<70dB(A)
Ambient temperature:	+10 to +40°C
Preset brew quantities:	Filter coffee 125 ml Caffè crema 125 ml Espresso 40 ml
Made exclusively for:	Tchibo GmbH, Überseering 18, 22297 Hamburg, Germany



Disposal

Dispose of the **packaging** at a recycling point that sorts materials by type. Make use of the local facilities provided for collecting paper, cardboard and lightweight packaging.



Appliances marked with this symbol must not be disposed of along with household refuse!

You are legally bound to dispose of old appliances separately from household waste. Information about collection points where old appliances can be disposed of free of charge is available from your local authorities.

Service Form

Please fill out the form in capital letters and send it along with the product.

Product number

(please fill in)

Surname, first name

Street, no.

Postcode, city

Country

Tel. (daytime)

Fault/Defect

Date of purchase

Date/Signature

(You can find your Cafissimo machine's product number on the type plate on the bottom of the casing.)

Return checklist:

- Package the product well.
- Secure any loose parts.
- Copy and include the proof of purchase.
- Remove any used capsules.

If not covered by the warranty* :

(please tick box)

- Please send back the coffee machine unrepaired.
- Please send a cost estimate.

*You will be responsible for the cost of returning any products which are not covered by the warranty.

